



ECR International

Parts Listing

Gas Fired Warm Air Furnace

Models:

GTH 050 – 100

GTM 050 – 100

GTM 085T – 100T



6800 Base Line, Wallaceburg, Ontario, N8A 5E5, Can. Tel: (519) 627-0791 Fax: (519) 627-4719
2201 Dwyer Avenue, Utica, New York, 13504 USA Tel: (315) 797-1310 Fax: (315) 724-9319
85 Middle Road, Dunkirk, New York, 14048, USA Tel: (716) 366-5500 Fax: (716) 366-1209
www.ecrinternational.com

PARTS LISTING: UPFLOW MODEL: GTH 50 - 100

Ref. No.	Description	GTH 50	GTH 70	GTH 85	GTH 100
Cabinet Group					
1	Top Panel	28863L	28863L	28727L	28727L
2	Rear Panel	28860L	28860L	28705L	28705L
3	Left Side Panel Assembly	28704L	28704L	28704L	28704L
4	Base Panel	28785	28785	28702	28702
5	Right Side Panel Assembly	28703L	28703L	28703L	28703L
6	Blower Division Panel Assembly	28917	28917	28914	28914
7	Upper Front Door Panel	28862L	28862L	28726L	28726L
	Logo Label	28673	28673	28673	28673
8	Lower Front Door Panel	28861L	28861L	28725L	28725L
	Door Handle – P2-41	28673	28673	28673	28673
Heat Exchanger Group					
10	Heat Exchanger Assembly	28867	28866	28750	28749
11	Flue Box Cover	28850	28850	28740	28740
12	Flue Box Gasket	28812	28812	28762	28762
13	Recovery Coil Assembly	28808	28808	28551	28551
14	Recovery Coil Gasket 48"	18199	18199	18199	18199
15	Heat Exchanger Tube Baffle	28745 (3)	28745 (4)	28745 (5)	28745 (6)
Blower Group					
20	Blower Complete With Wheel GT12-7 DD	28752	28752	-----	-----
	Blower Wheel for GT12-7 DD	29770	29770	-----	-----
20	Blower Complete With Wheel GT12-10 DD	-----	-----	17559	17559
	Blower Wheel for GT12-10 DD	-----	-----	29692	29692
21	Blower Motor ½ hp 4 Speed	26088	26088	-----	-----
	Blower Motor ¾ hp 4 Speed	-----	-----	27161	27161
22	Blower Slide Rail	28874	28874	28714	28714
23	Blower Motor Legs	17812 (3)	17812 (3)	17812 (3)	17812 (3)
24	Blower Motor Mounting Band	17811	17811	17811	17811
25	Control Panel	28783	28783	28710	28710
26	Blower Motor Capacitor ½ hp 10 mfd 370v	27743	27743	-----	-----
	Blower Motor Capacitor ¾ hp 20 mfd 370v	-----	-----	27745	27745
Electrical and Controls Group					
30	Transformer 120v/24v	27738	27738	27738	27738
31	Blower Door Safety Switch	19172	19172	19172	19172
32	Wire Harness Controls	28768	28768	28768	28768
	Wire Harness Blower	29747	29747	29747	29747
	Wire Harness Junction Box to Control	29748	29748	29748	29748
	Wire Harness Supply	29749	29749	29749	29749
33	Fan Timer Board ST9160B1035	28684	28684	28684	28684
34	Induced Blower Capacitor 4 mfd 370v	28689	28689	28689	28689
35	Induced Blower Replacement (IDB) Fasco	29793	29793	29793	29793
36	Gas Valve / Ignition Control SV9520M2403B	28683	28683	28683	28683
37 see notes	Pressure Switch IDB (Kit) (-1.40" w.c.) IS2 0140081F 5018 Tridelta	29730	29730	-----	29730
see notes	Pressure Switch IDB (-1.30" w.c.) IS2 0130071F 5017 Tridelta	-----	-----	29729	-----
38 see notes	Pressure Switch Heat Exch. (-0.50" w.c.) IS2 0050051F 5016 Tridelta	29731	29731	29731	29731

PARTS LISTING: LOWBOY MODEL: GTH 50 - 100

Ref. No.	Description	GTH 50	GTH 70	GTH 85	GTH 100
39	Primary Limit Switch (L-170 F) 36T01B3 3" Insertion	28688	28688	28688	28688
	Burner Group				
40	Inshot Burners Tab Loc	28697 (3)	28697 (4)	28697 (5)	28697 (6)
41	Natural Gas Burner Orifices	28758 (3)	28758 (4)	28758 (5)	28758 (6)
42	Manifold Pipe Assembly	28701	28700	28699	28698
43	Combustion Box	28865	28864	28729	28728
44	Burner Support	28735	28734	28733	28732
45	Tube Inlet Orifice Plate	28739	28738	28737	28736
46	Hot Surface Ignitor Norton 601 Type F 120V	28685	28685	28685	28685
47	Flame Sensor 8" Lead	28687	28687	28687	28687
48	Flame Roll-out Switch 36TX16 L-300 F	28695	28695	28695	28695
	Miscellaneous				
50	Drain Trap	27907	27907	27907	27907
51	Air Filter	2180023	2180023	2180023	2180023
52	Top Filter Rail	28781	28781	28781	28781
53	Bottom Filter Rail	28780	28780	28780	28780
54	Vent Tee Assembly	28847	28847	28846	28846
55	IDB Inlet Orifice (GTH 50 ONLY)	28878	-----	-----	-----
56	IDB Inlet Gasket	28814	28814	28814	28814
57	Drain Trap Gasket	28872	28872	28872	28872
58	Drain Line Tubing 1/2" ID X 18"	28637	28637	28637	28637
59	Drain Line Tubing 5/8" ID X 18"	28761	28761	28761	28761
60	Drain Line Elbow 1/2" OD 90°	28765	28765	28765	28765
61	Drain Line Elbow 5/8" OD 90°	28766	28766	28766	28766
62	Thumb Screws	28848 (2)	28848 (2)	28848 (2)	28848 (2)
62	Cage Nuts	28876 (2)	28876 (2)	28876 (2)	28876 (2)
63	Intake Air Fitting	28690	28690	28690	28690
63	Sight Glass Plug	28694	28694	28694	28694
63	Parts Bag Assembly	28879	28879	28879	28879
63	Pressure Switch Tubing 30"	21195	21195	21195	21195
	Conversion Kits				
	Natural Gas Conversion Kit (Altitude, 0-2000 ft)	28852	28852	28852	28852
	LP (Propane) Conversion Kit (Altitude, 0-2000 ft)	28851	28851	28851	28851
	High Altitude Conversion Kit LP (Propane) and Natural gas (Altitude, 2000-4500 ft)	28882	28882	28882	28882
	Concentric Vent Kits				
	2-Inch Concentric Vent Kit	29570	29570		
	3-Inch Concentric Vent Kit			29571	29571

Pressure Switch Notes:

If replacing original 28681 Pressure Switch, -1.40" w.c., Tridelta PPS10124-2740, Use Kit No. 29777.
 If replacing original 28680 Pressure Switch, -1.30" w.c., Tridelta PPS10124-2739, Use Kit No. 29776.
 If replacing original 28682 Pressure Switch, -0.50" w.c., Tridelta PPS10125-2741, Use Kit No. 29778.

MODEL GTH 50 - 100
DIAGRAM

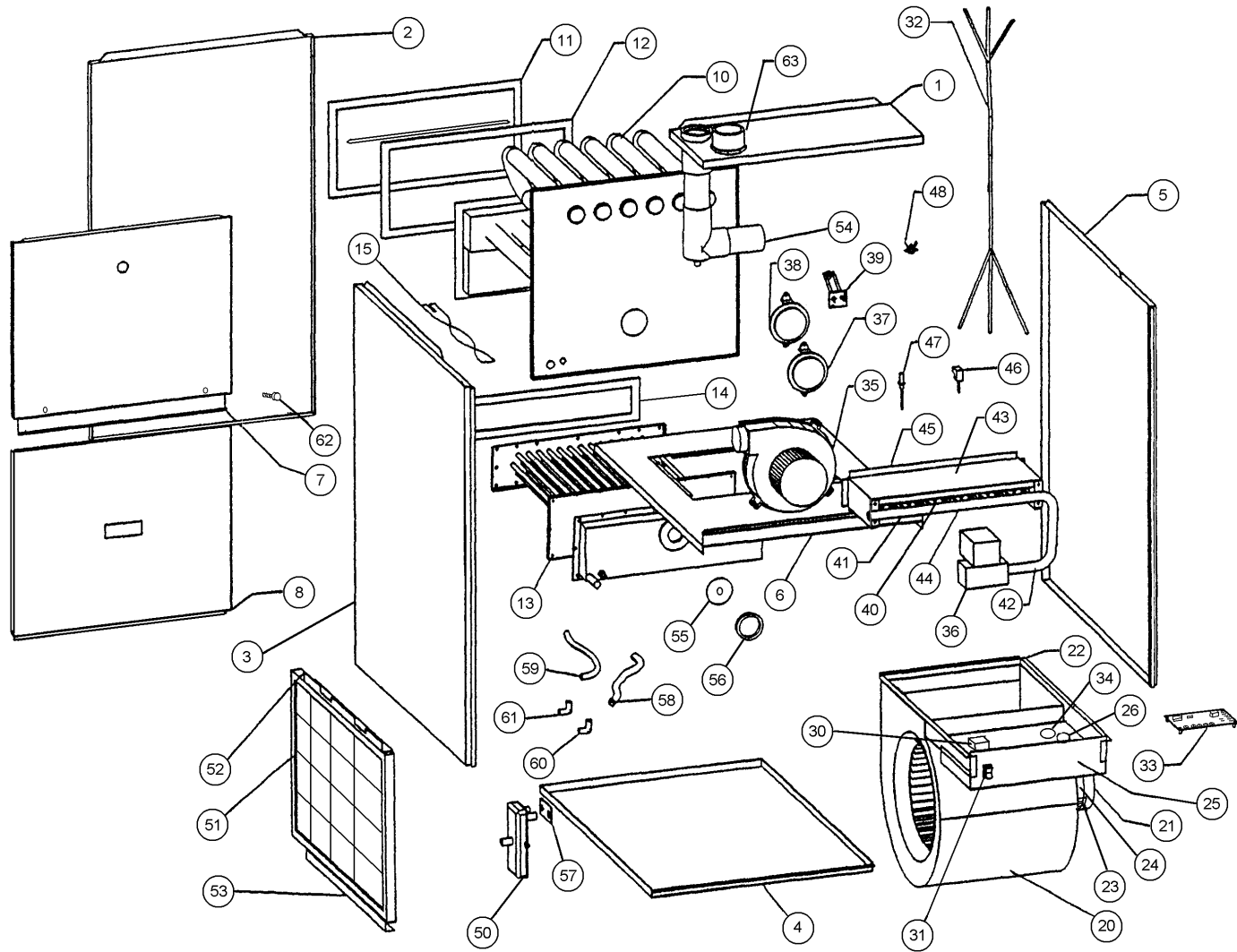

PARTS LISTING: UPFLOW MODEL: GTM 50 - 100

Ref. No.	Description	GTM 50	GTM 70	GTM 85 GTM 85T	GTM 100 GTM 100T
Cabinet Group					
1	Top Panel	29483L	29483L	29439L	29439L
2	Rear Panel	29507L	29507L	29508L	29508L
3	Left Side Panel Assembly	29510L	29510L	29510L	29510L
4	Base Panel	28785	28785	28702	28702
5	Right Side Panel Assembly	29509L	29509L	29509L	29509L
6	Blower Division Panel Assembly	29494	29494	29505	29505
7	Upper Front Door Panel	29440L	29440L	29441L	29441L
	Logo Label	29474	29474	29474	29474
8	Lower Front Door Panel	28861L	28861L	28725L	28725L
	Door Handle – P2-41	28673	28673	28673	28673
Heat Exchanger Group					
10	Heat Exchanger Assembly	29511	29512	29513	29514
11	Flue Box Cover	29453	29454	29455	29456
12	Flue Box Gasket	29481	29481	29482	29482
15	Heat Exchanger Tube Baffle	28745 (3)	28745 (4)	28745 (5)	28745 (6)
Blower Group					
Blower Parts for GTM 50 / 70					
20	Blower Complete With Wheel G10-8 DD	29496	29496	-----	-----
	Blower Wheel for G10-8 DD	26610	26610	-----	-----
21	Blower Motor 1/3 hp 3 Speed DD	29458	29458	-----	-----
22	Blower Slide Rail	29448	29448	-----	-----
23	Blower Motor Legs	26251 (3)	26251 (3)	-----	-----
24	Blower Motor Capacitor 7.5 mfd 370v	27742	27742	-----	-----
	Motor Mounting Band	17811	17811	-----	-----
Blower Parts for GTM 85 / 100					
20	Blower Complete With Wheel G10-10 DD	-----	-----	15011	15011
	Blower Wheel for G10-10 DD	-----	-----	26430	26430
21	Blower Motor 1/2 hp 4 Speed DD	-----	-----	26088	26088
22	Blower Slide Rail	-----	-----	29449	29449
23	Blower Motor Legs	-----	-----	26251 (3)	26251 (3)
24	Blower Motor Capacitor 10 mfd 370v	-----	-----	27743	27743
	Motor Mounting Band	-----	-----	17811	17811
Blower Parts for GTM 85T / 100T					
20	Blower Complete With Wheel GT12-10 DD	-----	-----	17559	17559
	Blower Wheel for GT12-10 DD	-----	-----	29692	29692
21	Blower Motor 3/4 hp 4 Speed DD	-----	-----	27161	27161
22	Blower Slide Rail	-----	-----	29449	29449
23	Blower Motor Support Legs	-----	-----	17812 (3)	17812 (3)
24	Blower Motor Capacitor 3/4 hp 20 mfd 370v	-----	-----	27445	27445
	Motor Mounting Band	-----	-----	17811	17811
25	Control Panel	29450	29450	28710	28710
Electrical and Controls Group					
30	Transformer 120v/24v	27738	27738	27738	27738
31	Blower Door Safety Switch	19172	19172	19172	19172

PARTS LISTING: LOWBOY MODEL: GTM 50 - 100

Ref. No.	Description	GTM 50	GTM 70	GTM 85 GTM 85T	GTM 100 GTM 100T
32	Wire Harness Controls	29421	29421	29421	29421
	Wire Harness Blower	29747	29747	29747	29747
	Wire Harness Junction Box to Control	29748	29748	29748	29748
	Wire Harness Supply	29749	29749	29749	29749
33	Fan Timer Board ST9160B1035	28684	28684	28684	28684
35	Induced Blower Replacement (IDB) Jakel	29794	29794	29794	29794
36	Gas Valve / Ignition Control SV9520M2403B	28683	28683	28683	28683
37	Pressure Switch IDB (-0.55" w.c.) IS20136-3306	29490	29490	29490	29490
39	Primary Limit Switch 60T11 (L-180 F) BOF	28654	28654	28654	28654
39	Primary Limit Switch GTM 85T / 100T ONLY 60T11 (L-150 F) BOF	-----	-----	29197	29197
	Burner Group				
40	Inshot Burners Tab Loc	28697 (3)	28697 (4)	28697 (5)	28697 (6)
41	Natural Gas Burner Orifices (Altitude, 0-2000 ft)	28758 (3)	28758 (4)	28758 (5)	28758 (6)
42	Manifold Pipe Assembly	29426	29427	29428	29429
43	Combustion Box	29442	29443	29444	29445
44	Burner Support	28735	28734	28733	28732
45	Tube Inlet Orifice Plate	28739	28738	28737	28736
46	Hot Surface Ignitor Norton 601 Type F 120V	28685	28685	28685	28685
47	Flame Sensor 8" Lead	28687	28687	28687	28687
48	Flame Roll-out Switch 36TX16 L-300 F	28695 (2)	28695 (2)	28695 (2)	28695 (2)
	Miscellaneous				
51	Air Filter	2180023	2180023	2180023	2180023
52	Air Filter Frame	18020	18020	18020	18020
53	Filter Frame End Support	5592B2	5592B2	5592B2	5592B2
55	Vent Box Assembly	26912	26912	26912	26912
56	IDB Gasket	28814	28814	28814	28814
62	Thumb Screws	28848 (2)	28848 (2)	28848 (2)	28848 (2)
	Cage Nuts	28876 (2)	28876 (2)	28876 (2)	28876 (2)
	Pressure Switch Tubing 9"	11344	11344	11344	11344
	Conversion Kits				
	Natural Gas Conversion Kit (Altitude, 0-2000 ft)	28852	28852	28852	28852
	LP (Propane) Conversion Kit (Altitude, 0-2000 ft)	28851	28851	28851	28851
	High Altitude Conversion Kit LP (Propane) and Natural gas (Altitude, 2000-4500 ft)	28882	28882	28882	28882

MODEL GTM 50, 70, 85, 85T, 100, 100T
DIAGRAM

