

Olsen

Heating & Cooling Products

An ECR International Brand

Multiposition Oil Furnaces

WML & MPL Downflow/Horizontal Front Breech

- Designed for maximum comfort
- Delivers up to 82% efficiency
- Clean and quiet operation
- Lifetime warranty on the heat exchanger

*Keeping families
warm for more
than 60 years.*



A History of Quality

Although we started by producing horse-drawn carriages, automobiles and military equipment, ECR International expanded our design and manufacturing capabilities during World War II and "Olsen" quickly became a household word for quality furnaces.

From our factory in southwestern Ontario, we at ECR International continue our commitment to oil heat by engineering and manufacturing a full line of top-quality, high-efficiency residential oil furnaces.

The Olsen name continues to be synonymous with "superior, reliable oil heat" and the Multiposition product line-up has been keeping families warm for more than 60 years.

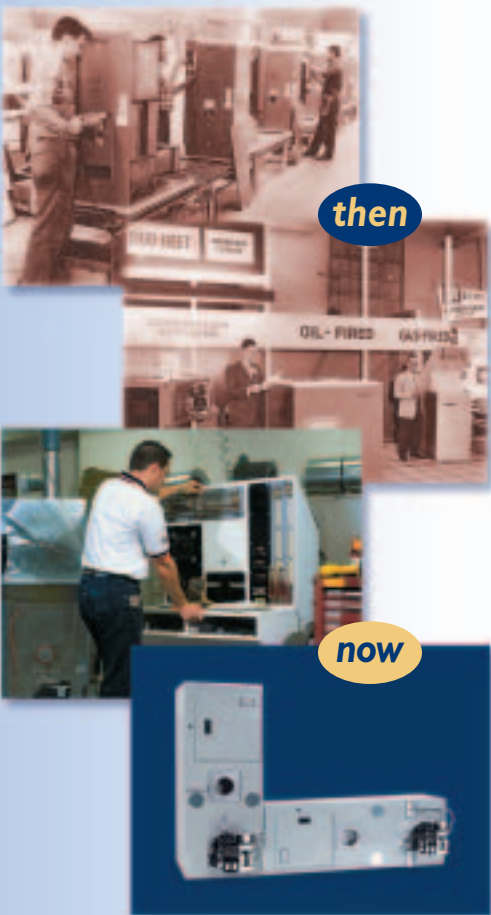

Comfort

The Olsen Multiposition series of oil-fired furnaces provide the best value in heating comfort for your family. "Comfort" in knowing that you will provide the warmth your family needs. Multiple speed blowers allow airflow to be matched with the needs of your home eliminating "gusts" of hot or cold air and increasing overall comfort. Your family's comfort is further ensured due to our large washable filters that provide for greater air filtration and cleaner room air.

Efficiency

Olsen's Multiposition oil-fired furnace designs are capable of achieving up to 82% efficiency due to Olsen's unique heat exchanger design, high performance oil burners and increased fibre-reinforced foil faced cabinet insulation. The result is increased energy savings and lower fuel bills.

Clean and Quiet Operation

Each Olsen Multiposition furnace has a completely insulated combustion chamber to provide quiet operation and clean burning performance. The oil burner is equipped with a solenoid oil valve that ensures clean starts and quiet shut-downs of the burner.

Reliability

Olsen Multiposition furnaces are constructed with 100% welded, heavy-gauge steel heat exchangers that come standard with a limited lifetime warranty. Multi-speed blowers, high-quality motors and components all provide peace-of-mind for years of worry-free service. Strong 20-gauge cabinet panels feature a baked-on epoxy-based powder coating, resistant to scratching, peeling and corrosion, which protects your investment.

Olsen's **Limited Lifetime Warranty** is among the best in the industry! Every Olsen furnace comes with our guarantee to the original purchaser that the heat exchanger will be free from defects in materials and workmanship as long as you own the appliance...

... or we'll supply a replacement heat exchanger free of charge!



Our **Five-Year Parts Warranty** provides even more assurances. Olsen warrants to the original purchaser that any component of the furnace will be free from defects in materials and workmanship for a period of five full years...

... or we'll supply a replacement part free of charge!

* Subject to the limitations set out in the warranty.



Features & Benefits of the Olsen Multiposition Oil Furnace

1 Insulated Cabinet: Heavy gauge panels are coated with a baked-on epoxy-based powder paint that resists scratching and are insulated with 1/2" thick fibre-reinforced foil-faced insulation that retains heat and quiets operation.

2 Dual Pass Heat Exchanger: The two paths slow the flue gases and reduce pressure drop thereby enhancing heat transfer. Our unique square heat exchanger design creates added flue gas turbulence, which also increases efficiency. Each heavy gauge heat exchanger is precision made, 100% welded and pressure tested for the highest possible quality.

3 Barometric Draft: Each furnace comes with a standard chimney vent draft regulator to provide a constant negative pressure for optimum chimney vent models.

4 Fan Control Centre: Electronic fan timer board controls the blower for delayed on/off operation that eliminates cold air start-up and maximizes heat utilization on shut-down. Wiring is colour coded, equipped with connections for easy air conditioning, humidifier or air cleaner installation. A terminal strip is also supplied for easy thermostat connections.

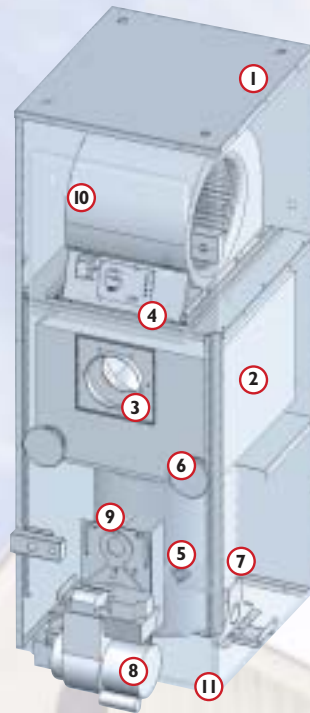

5 Fan Limit: A snap disc limit is smartly located to eliminate potential overheating and premature heat exchanger fatigue.

6 Dual Clean-Out Ports: Large and easily accessible clean-outs make service and cleanings thorough and quick.

7 Washable Filter System: An extra large filtration area and washable filter are included with the furnace. This provides greater air filtration and cleaner room air.

8 Oil Burners: Beckett flame retention head burner includes factory supplied solenoid valve on pump for cleaner and quieter operation with reduced maintenance, 14,000-volt ignition, interrupted primary control and ball-bearing PSC motors reduce energy consumption. Optional Riello oil burners also available.

9 Combustion Chamber: Ceramic fibre combustion chamber helps ensure clean combustion, and provides for quiet operation of the furnace.

10 Blower Assembly: Direct drive blowers can be set up for multiple speeds allowing airflow to be matched with the needs of your home eliminating "gusts" of hot or cold air and increasing overall comfort. Removal of two bolts allows the assembly to slide out easily for maintenance.

11 Combustible floor base available for units installed in the *downflow* position.

Both the WML and MPL can be installed in either downflow or horizontal positions.



WML

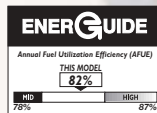

- Front Breech
- Downflow/Horizontal
- Direct Drive
- Firing Rates 58, 75, 85 BTU/h (000's) output (Factory standard 75 output)
- DirectVent model available
- Air conditioning ready, up to 3 tons

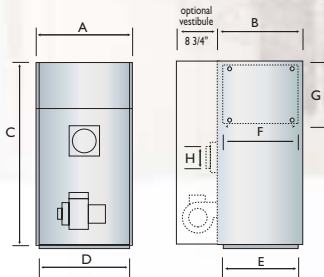

WML Dimensions

Cabinet			Plenum Openings			Flue Dia (H)	Filter	Shipping Weight lbs.
Width (A)	Depth (B)	Height (C)	Supply Air (D x E)	Return Air (F x G)				
22	22 1/8	55 1/4	19 x 19	18 x 18	18 x 18	5	20 x 20 x 1	265



MPL

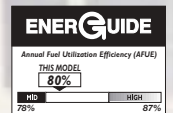

- Front Breech
- Downflow/Horizontal
- Direct Drive
- Firing Rates 85, 96, 112, 123 BTU/h (000's) output (Factory standard 112 output)
- DirectVent model available
- Air conditioning ready, up to 3 tons

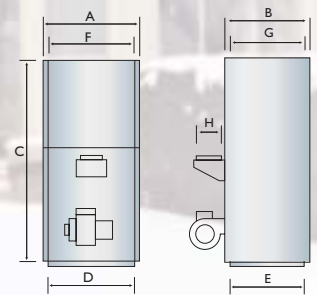

MPL Dimensions

Cabinet			Plenum Openings		Flue Dia (H)	Filter	Shipping Weight lbs.
Width (A)	Depth (B)	Height (C)	Supply Air (D x E)	Return Air (F x G)			
22 1/4	22 1/4	62	20 1/2 x 20 1/2	18 x 18	6	20 x 20 x 1	292

Specifications - Multiposition Oil Furnaces

(all specifications indicated are for factory standard production)

Model	WML 80 C	MPL 120 B
BTU/h Input	91,500	140,000
BTU/h Output	75,000	112,000
*Firing Rate - USGPH	0.65	1.0
Burner Model (Beckett)	AF76BNHS	AF76XN
Nozzle (Factory Standard)	80°A	60°A
Blower - Direct Drive	GT10	GT12-10
Max. CFM @ .20" WC SP-Dir.	1505	1553
Max. CFM @ .50" WC SP-Dir.	1291	1331
Cooling Capacity (Tons)	3	3
Motor (PSC)	1/2 HP 4SP	3/4 HP 4SP
Temperature Rise	45°F - 75°F	50°F - 80°F
Permanent Filter	20" x 20" x 1"	20" x 20" x 1"
Shipping Weight	265 lbs.	292 lbs.
AFUE Rating	82%	80%

* Additional firing rates available.

DIRECT VENT SIDEWALL

Direct Sidewall Venting is an effective alternate method of venting combustion products through an outside wall of

the house, rather than up a traditional chimney. This method utilizes the burner to efficiently exhaust products of combustion from the heating equipment.

FEATURES AND BENEFITS

- Direct Sidewall Vent allows for overall increase in installed appliance efficiency of a minimum of 1% AFUE.
- The Olsen Direct Sidewall Vent kit has been designed for flexibility in installation. All vent-to-appliance adapters are included.
- Every Direct Sidewall Vent installation requires an Olsen Vent Terminal in addition to the venting kit described above. The Olsen Vent Terminal utilizes a two-pipe combustion air/exhaust gas configuration. Because outside air is used for combustion, the system provides greater efficiency and safety in new, tightly sealed houses.
- Only one wall opening is required for concentric vent.
- The burner provides the necessary pressure for adequate venting of flue products - no additional motors or controls are required.



ECR International

The **Single Source SOLUTION**
for HVAC Products



Ask your installer about our central air conditioners and heat pumps!



Clearance to Combustibles (Inches)				
	WML-C		MPL-B	
	Downflow	Horizontal	Downflow	Horizontal
Top	0	3	0	3
Bottom	1	1	1	1
Front	10*	10*	10*	10*
Rear	1	1	1	1
Side 1	1	1	1	1
Side 2	1	1	1	1
Flue Pipe	9**	9**	9**	9**
Enclosure	Closest	Closest	Closest	Closest

All measurements are in inches.

* 24" is required for servicing.

** 18" in U.S.A.

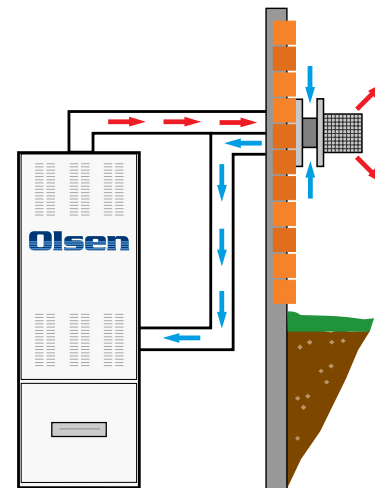

WML & MPL Heating Output & Burner Data - Direct Vent

Beckett AFII Series Oil Burners (For use with sidewall vented units using outdoor combustion air)						
Furnace Model	Output BTU/h	Burner Model	Nozzle	Pump Pressure	Flow Rate	Head
WML-60CB2	63,500	AFII-85	0.50 / 60°A	120 PSIG	0.55 USGPH	FB0
* WML-80CB2	75,000	AFII-85	0.60 / 60°A	115 PSIG	0.65 USGPH	FB3
WML-90CB2	85,600	AFII-85	0.70 / 60°A	115 PSIG	0.75 USGPH	FB3
MPL-90BB2	85,500	AFII-150	0.70 / 60°A	145 PSIG	0.75 USGPH	FB0
MPL-100BB2	96,000	AFII-150	0.80 / 60°A	145 PSIG	0.85 USGPH	FB3
* MPL-120BB2	112,000	AFII-150	0.85 / 70°A	145 PSIG	1.00 USGPH	FB3

* Factory standard production.

In Canada contact:

ECR International Ltd. - Olsen Division

P.O. Box 900, 6800 Base Line

Wallaceburg, Ontario, Canada N8A 5E5

Tel: (519) 627-0791 Fax: (519) 627-4719

Web: www.ecrltd.com



In the USA contact:

ECR International

85 Middle Rd., Dunkirk, NY 14048

Tel: (716) 366-5500 or (877) 386-5475

Fax: (716) 366-1209

Web: www.ecrinternational.com

USA Homeowner Assistance: (866) 847-6656

USA Contractor Technical Assistance: (800) 325-5479

ECR International

2201 Dwyer Ave., Utica, NY 13504

Tel: (315) 797-1310 or (800) 325-5479

Fax: (315) 724-9319

All product specifications reflect available information at the time of printing. ECR reserves the right to revise or modify products without notice.

Part#24204 MLTOE 10/06